

Please **pray** for our leadership as we make plans to develop this property to be used as our base camp for sending our missionary teams throughout the state.

Pray for God to move powerfully in the hearts of His people to give. **This is His property and will be used for building His Kingdom in Alaska.** We dedicate this land to Him and for His glory!



Thank you for giving towards this need for building materials. We have skilled men and women who are ready to do the work.

This much needed building will be the place for us to steward the tools that God has already given us to bless others in Alaska. It is an honor to work together to see the Name of Jesus Christ be praised!



LIGHTSHINE MINISTRIES
P.O. BOX 777
MOUNT JOY, PA 17552

lightshinealaska@comcast.net

www.lightshineministries.org



LightShine Ministries

PHASE 2
We Need Your Help
Purchasing Building
Materials



“And let the beauty of the Lord our God be upon us, And establish the work of our hands for us; Yes, establish the work of our hands.

Psalm 90:17

EXCITING NEWS!

In October of last year we were able to raise \$40,000 in 5 weeks from God's people to purchase 4.62 acres in Palmer, Alaska for our missionary base of operations. **Plans are being made to build a garage for our vehicles and tools from the harsh Alaskan winter.** In addition to 8 other teams that are serving over the summer, this coming August, we are planning three teams to build this much needed building. **We need your help in purchasing building materials.**

OUR HISTORY:

LightShine Ministries has been serving in Alaska Native villages, building churches, three different youth Bible camps, a support building at a remote Christian radio station, at Youth With A Mission (YWAM) Arctic Mercy and various other ministry buildings and projects in Alaska since 1995. **Approximately \$72,000 in skilled labor was given in 2017.**

We specialize in mobilizing men and women to do specific missionary assignments in Alaska and work through the local church (both in Alaska and in Pennsylvania) to provide the people needed to accomplish great things for building up the Kingdom of Jesus Christ in Alaska! Lives are being changed!

In April, **Tom Denlinger** and **Mel Miller** spent a week in Alaska determining the placement of our garage, meeting with local officials and gathering important information. **Go to our website to see a YouTube video report.**

www.lightshineministries.org



Our Director of Facilities, **Mel Miller**, is leading our Design Team (pictured above in the white shirt and in the photo with the artist rendering to the right) with Ministry Director – **Tom Denlinger** (behind the camera). **Steve Hoey** (in the blue shirt) is our Director of Team Leader Development and is also an electrician. **Bill Endslow** (far right) is leading the Excavating and Foundation Crew in early August. **Carl Ginder** (next to Bill) is our Board Chairman and retired as a site development professional. **Ron Good** (center) is leading the Framing and Roofing Crew on August 23rd. **Ben Ebersole** (not in this photo) designed the trussing and prepared actual blueprints for the building construction.



In this photo, you will see the approximate location of our 28'x60' garage. This garage will have a kitchen, dining room and bathroom in the walk-in door area and steps to go upstairs where there will be an area to set up our cots for housing teams till we are able to build our main lodge in the future (Phase 3). The following teams are ready to build in August!

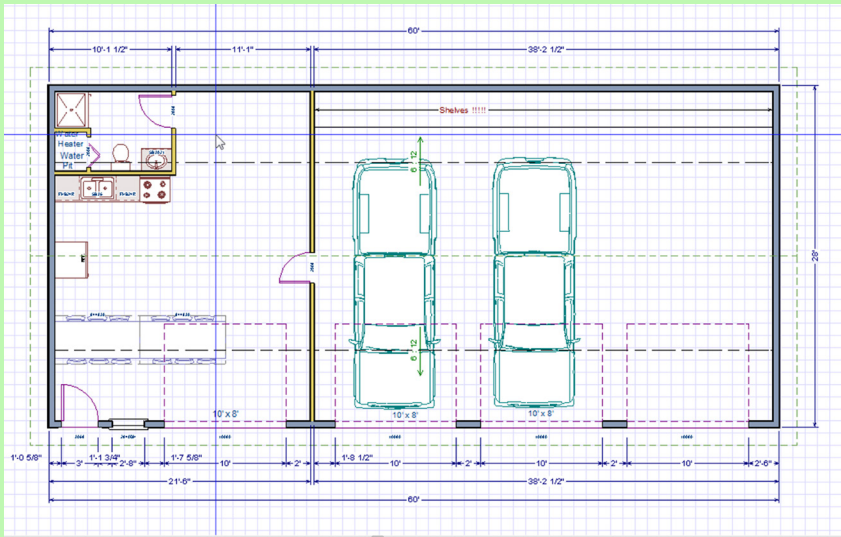

Excavating Crew
August 4-11
\$3,000 for materials

Foundation Crew
August 11-19
\$11,010 for materials

Framing & Roofing Crew
August 23 - September 1
\$25,836 for materials

Interior Finishing Work
Dates to be determined!
\$40,000 estimated

TOTAL NEEDED FOR PHASE 2
\$80,000

HERE IS OUR 4 YEAR PLAN:
The property currently has a 2 bedroom house on it which we will continue to rent until we can place several staff people there to be caretakers of our missionary base.

PHASE 1 - 2017 Completed!

Praise the LORD! We are very thankful that God's people gave towards the purchase of this 4.62 acre property!

PHASE 2 - 2018

Please consider giving to help us purchase the building materials for this much needed garage. We desire to keep our vehicles and tools inside over the harsh Alaskan winter. This building will also be able to be a temporary facility to house our teams until we are able to build a larger bunk house in the future. **The total estimated cost for this phase is \$80,000.** You can go to our website and look at the specific list of materials and plans for this project.

PHASE 3 - 2019-2020

The long-term goal will be building our main lodge that will house our teams for future service.